

# Chrysanthemum

By TrendSetter Nichole Starman

Copyright 2015 © Starman, Inc. & Artist. Not licensed for digital distribution.  
Promotional use only—no resale of instructions permitted. Version 1.0

## BUILDING BLOCKS OF MODERN BEADING

Combine CzechMates 2-Hole Crescent and Lentil beads to form a puffy dimensional flower.



## ABOUT THE ARTIST: NICHOLE STARMAN



Nichole has been an integral part of the industry wholesaling Czech glass since the year 2000. She has produced some of the world's most notable styles and colors of beads. Nichole loves the infinite possibilities using the bead color palette to create wearable works of art. The introduction of TOHO brand seed beads into her work has given new dimension to designing with Czech glass. Visit [www.facebook.com/nichole.starman.1](http://www.facebook.com/nichole.starman.1)

COLORWAY: CzechMates® Crescent™ (new colors to be announced); CzechMates® Lentil Metallic Suede Lt. Green (366-06-79051); 6mm Round Metallic Suede Gold (5-06-79080); TOHO Round 11° Nickel (TR-11-711); TOHO Round 8° Inside-Color Aqua/Gold Lined (TR-08-284).

## MATERIALS

- 112 CzechMates® Crescents (CMC)
- 112 CzechMates® Lentils (CML)
- 7 6mm Rounds (R6)
- 6 8° TOHO Seed Beads (SB8)
- 128 11° TOHO Seed Beads (SB11)
- Clasp of choice
- One-G Thread

Each flower measures approx. 1"  
Bracelet measures approx. 7" in length

## INSTRUCTIONS

1. On 2 yards of thread, add CML and CMC. Repeat for a total of 16 each. Pass through all of the beads again, then tie a knot. Continue through the next CML and CMC then jump to the second hole. Be sure that the Crescents are added in the same direction each time, otherwise they will be incorporated upside down.
2. Pass through all of the open inner holes of the CMC twice, then exit through the CMC you started from in this step.
3. Add RB6. Pass around the thread between CMC on the opposite side, then pass back through RB6. Pass around the thread twice, then through the CMC. Jump to the second hole of the CMC. Pass through the CML, then jump to the second hole.
4. Add SB11, pass through an open CML. Repeat 15 times for a total of 16 SB11. Pass through all beads again. Exit the CML you started from in this step then tie off. Follow Steps 1 through 4 to make a total of seven flowers.
5. **Join the flowers together to form a bracelet:** Using a new length of thread, pass through an existing SB11 on a finished flower, then add SB8. Pass through a SB11 on a second flower from the same direction as the first flower. Pass through the SB8 again, then pass into the SB11 on the first flower from the same direction that you started from as shown. Pass through all of the beads in this step again, then tie-off.  
Link all 7 flowers in this manner. Connect from different SB11 along the perimeter of each flower to create a staggered look, or use the SB11 directly across from the previous link to connect them in a straight line.
6. **Connect the clasp:** Using a new length of thread, pass through an SB11 on an end of the bracelet. Add four SB11, clasp, four SB11, then pass through the SB11 on the end of the bracelet again. Pass through all beads in this step again, then tie-off. Repeat for the second side of the bracelet.

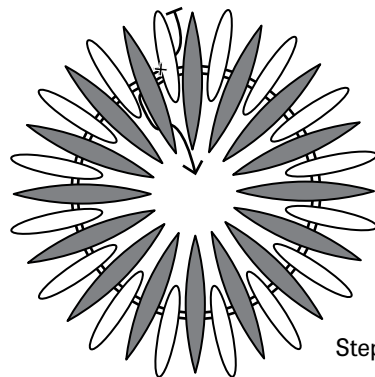

Step 1

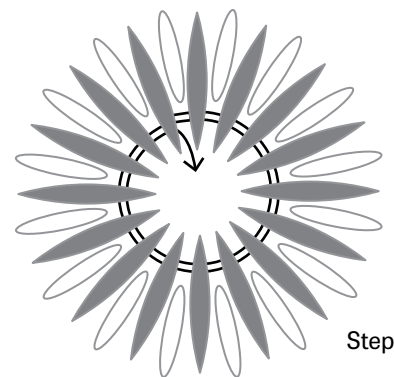

Step 2

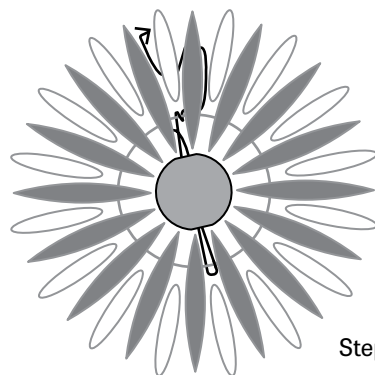

Step 3

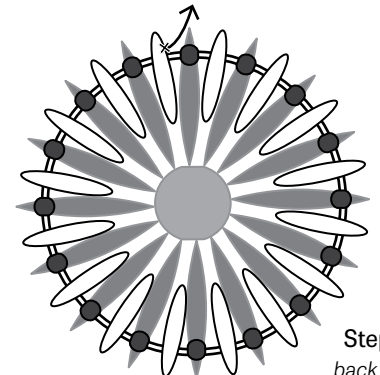

Step 4  
back side

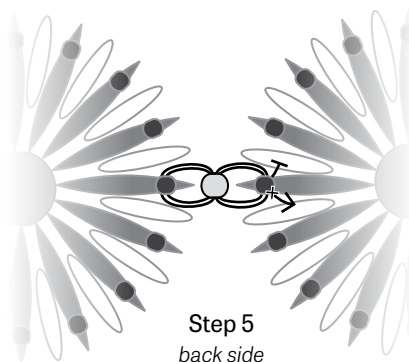

Step 5  
back side

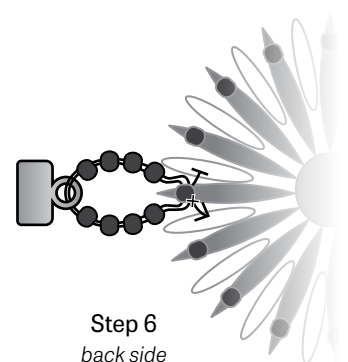

Step 6  
back side