

STARMAN

# COLOR TRENDS

## Mirror

Reflective colors in brilliant jewel-tones. Available in: CzechMates® Tile; 3mm Rondelle; 2mm Firepolish.



15226 Cranberry



K5903 Fuchsia



K5513 Teal



K5203 Orchid



K5507 Fern Green



K5308 Denim

Copyright © 2015 Starman, Inc.

# TAKE & MAKE



Created with CzechMates®, exclusively manufactured by Starman in the Czech Republic.



### TrendSetter Chloe Menage

An experienced jewellery designer and teacher, Chloe was previously editor of the popular magazine *Bead & Jewellery*. A love of beads and all things sparkly lead to the creation of her own jewelry business, Pinkhot, based in West Sussex, UK. Chloe teaches at jewellery making workshops and sells at craft fairs across the country. [www.Pinkhot.co.uk](http://www.Pinkhot.co.uk)

## Double Tile Bangle

by TrendSetter Chloe Menage

courtesy of

MANUFACTURING BEADS SINCE 1948  
**STARMAN**

# Double Tile Bangle

by TrendSetter Chloe Menage

Copyright 2015 © Starman, Inc. and Artist.  
Not licensed for digital distribution. Version 1.0

## ABOUT THE CZECHMATES QUADRATILE:

The low profile thickness and flat surface area make the QuadraTile a universal component that adds structural integrity and connectivity without bulk. It's a great base plate for arches and foundations in dimensional designs.

## MATERIALS

- 24 CzechMates® QuadraTile (QT)
- 24 CzechMates® Tile, Color 1 (CT1)
- 24 CzechMates® Tile, Color 2 (CT2)
- TOHO One-G Thread
- Thread Wax

*Creates 7" bangle. For a bigger bangle, increase by four CzechMates Tile.*

## COLORWAYS

Blue: 387-06-27000, 250-66-K5308, 250-66-K5513.  
Fuchsia: 387-06-27000, 250-66-K5903, 250-66-15226.

TRENDSETTERS

## INSTRUCTIONS

1. Put a needle on 6ft of thread, double over and wax well.
2. Pick up QT, CT1, QT, CT2, and repeat until 24 pairs of QT and CT are strung on. Form a loop by tying the ends in a square knot. Pass through a few beads and exit a CT2.
3. To reverse direction, jump through the open hole of the current CT2. Pass into an open hole of the adjacent QT, pulling the CT2 up 'flat'.
4. Add CT1, allowing it to dangle next to the adjacent CT1, then pass through the corresponding open hole on the next QT. Pass through the second (open) hole of the next CT2, pulling it up to sit flat, then pass through the next QT. Repeat adding CT1s and passing through CT2s for the entire bangle.
5. To reverse direction, pass through the first CT1 added in this step, the next QT, then jump down diagonally through an open hole of the QT.

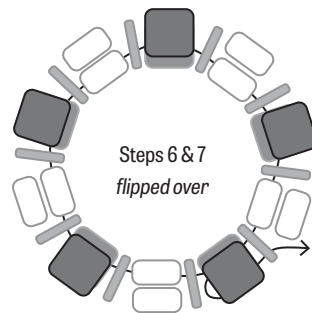
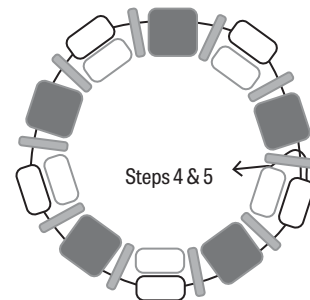
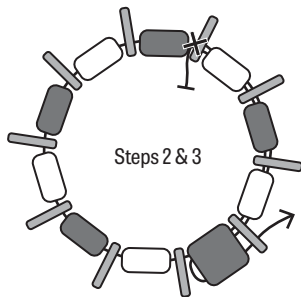

6. Flip the piece over. Pass through the open hole of the adjacent CT1, and the corresponding open hole of the next QT, securing the CT1 in to place. Add CT2, then pass through the corresponding open hole of the next QT. Repeat adding CT2s and passing through CT1s for the entire bangle.
7. To reverse direction, jump through the open second hole of a CT2 added in this step, then pass through the remaining open hole of the adjacent QT.
8. For the final round, pass through all remaining open holes, securing all CTs in to place. If your piece needs more tension, continue passing around the ring, pulling tight as you go. To tie off with a few half-hitch knots, passing through a few beads between knots, before trimming the ends.

