

STARMAN

# COLOR TRENDS

## PolyChrome

The many layers of color and texture within the surface of these beads create a metallic effect of a new dimension. The coordinated colors seamlessly shift and contrast with even the slightest movement. CzechMates® Tile, Brick, Triangle; Firepolish; Round; SuperDuo; Rondelle; Tear Drop; Melon; Pinch.



94105 Indigo Orchid



94104 Aqua Teal



94101 Black Currant



94102 Orchid Aqua



94100 Copper Rose



94103 Olive Mauve

Created with TOHO professional quality seed beads and Starman quality Czech glass.



## TAKE & MAKE



### TrendSetter Anna Lindell

I'm a Swedish bead artist who has been beading since 2007, and a few years ago my hobby turned into a business. I'm having the time of my life creating fun designs for tutorials, travelling around teaching classes, and sharing my love for beads. The sky is the limit, with beads you can make anything you want. [www.TigerGuld.com](http://www.TigerGuld.com)

## Spheric Earrings

by TrendSetter Anna Lindell

courtesy of



# Spheric Earrings

by TrendSetter Anna Lindell

Copyright 2015 © Starman, Inc. and Artist.  
Not licensed for digital distribution. Version 1.0

**ABOUT THE CZECHMATES BAR:** This dainty little connector is a powerful dimensional tool that seamlessly integrates into any form of beadwork. Its contemporary shape adds understated elegance whether it is being used in simple stringing designs, intricate bezels, or three-dimensional components.

## MATERIALS FOR 2 EARRINGS

60 CzechMates® Bar (CMB)  
42 Firepolish 3mm (FP3)  
12 Firepolish 4mm (FP4)  
4 Melon 8mm (M8)  
1g 8° TOHO Seed Beads (SB8)  
1g 15° TOHO Seed Beads (SB15)  
2 3" Headpins, 2 Earwires, Thread,  
Roundnose Pliers, Wire Cutter

COLORWAYS: Blue: 389-26-27000, 1-03-94105, 1-04-94105, 287-08-2398,  
TR-08-81, TR-15-82. Bronze: 389-26-14415; 1-03-LR13060, 1-04-LR13060,  
287-08-R14415, TR-08-221, TR-15-224.

TRENDSETTERS

## INSTRUCTIONS

1. Add a stop bead to a yard of thread. Pick up \*SB8, CMB, SB15, CMB, SB15, CMB, SB8, CMB, SB15, CMB, SB15, CMB, \*SB8. Pass through the open hole of the last CMB added. [\*These SB8s will be shared beads in Step 3.]
2. Add FP3, pass through the open hole of the next CMB, add FP3, pass through the open hole of the next CMB, add FP4, pass through the open hole of the next CMB, add FP3, pass through the open hole of the next CMB, add FP3, pass through the open hole of the next CMB and the first SB8 from Step 1.
3. Repeat Steps 1 and 2 four times for a total of five 'arches,' *except for adding the first and last SB8 in the sequence. Instead, pass through the existing SB8s.*

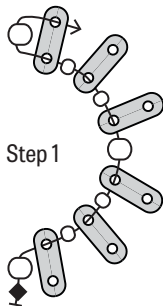

Step 1

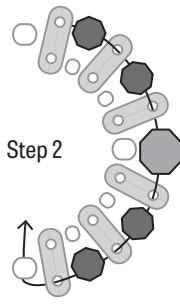

Step 2

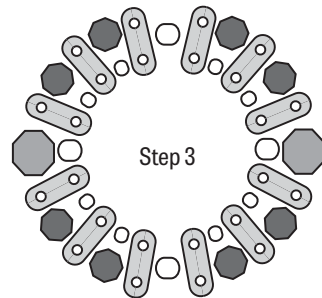

4. Add SB8, M8, SB8 in the middle of the arches and pass outwards through the existing SB8 on the opposite side. Then pass through the outer holes of an arch to the stop bead. Knot the ends together and tie off.

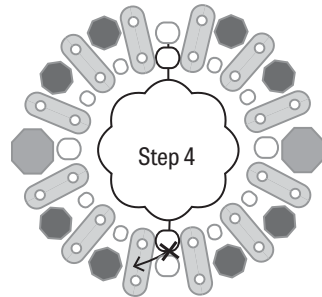

5. Pick up a headpin and add SB15, M8, FP4, FP3, SB8. Pass up through the two SB8s, M8, and two SB8s in the center. Add one SB8. Form a wrapped loop and trim excess wire. Attach an earwire to the loop.

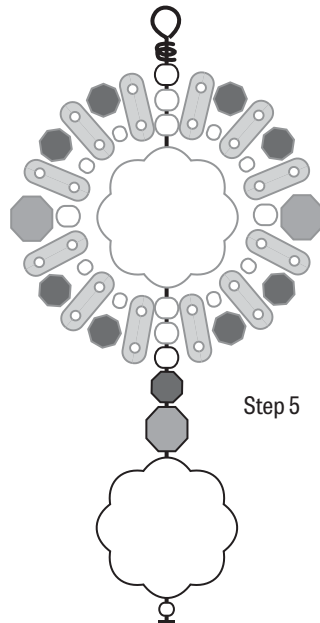

Step 5