

Titania Bracelet

By TrendSetter Megan Milliken

Copyright 2015 © Starman, Inc. & Artist. Not licensed for digital distribution.
Promotional use only—no resale of instructions permitted. Version 1.0

STARMAN
TRENDSETTERS

THE BUILDING BLOCKS OF MODERN BEADING

Structural designs build quickly and easily with the CzechMates® Dimensional Beading System.



ABOUT THE ARTIST: MEGAN MILLIKEN



Megan Milliken has been crafty her whole life, which led her to beading and jewelry design since 2000. She studied at Parsons, The New School for Design. She also designs for her personal jewelry lines, MaeMaeMills and Megan Milliken Designs. Megan has taught jewelry-making techniques, knitting, crochet, and sewing to numerous private clients, and has been published many times. Visit www.meganmillikendesigns.com

COLORWAYS: Green—CzechMates Bar Jet (389-26-2398); Czech Tear Drop Chrome Emerald Green (106-64-94204); TOHO Round 15° Gold-Lustered Dk. Topaz (TR-15-459); TOHO Round 11° Rainbow/Jonquil/Forest Green Lined (TR-11-1829).
Bronze—CzechMates Bar Matte Metallic Flax (389-26-K0171); Czech Tear Drop Matte Metallic Bronze Iris (106-64-K0164); TOHO Round 15° Higher-Metallic Purple/Green Iris (TR-15-509); TOHO Round 11° Bronze (TR-11-221).

INSTRUCTIONS

- On a comfortable length of thread, add 7 SB15. Form a ring and tie a double knot against the tail. Pass through the ring again for strength. [Note: depending on your clasp, you may stitch it in to this loop, or attach it to this loop later with a jump ring.]
- Bar Segment:** Add two SB15, one SB11, TD, SB11, CMB, SB11, TD, SB11. Pass through the second hole of CMB, then pass through the first SB11, TD, SB11 added in this step.
 - Add three SB15, then pass back through the second SB15 just added. Add SB15, then pass through the SB11, TD, SB11 on the second side of the CMB. Add SB15, then pass through the first SB15 added in Step 2a. Pass through the adjacent SB15 on the ring, then pass back through the first SB15 added in Step 2a. Pass through the beads on the first side of the CMB until exiting the SB15 as shown.

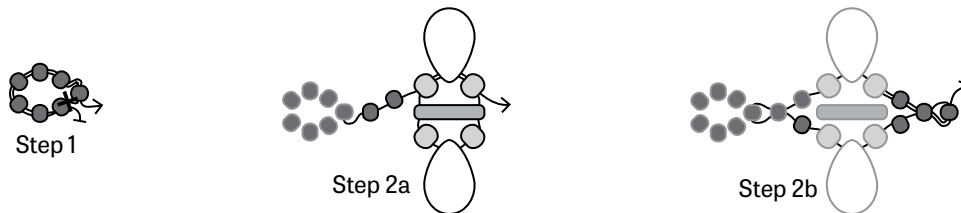

- Diamond Segment:** Add two SB11 and one SB15. Pass back through the second SB11 added.
 - Add SB11, SB15, two SB11, and one SB15. Pass back through the last SB11 added.
 - Add SB11. Pass through the SB15 at the top. Pass through the piece until exiting the first SB15 added in Step 3b.

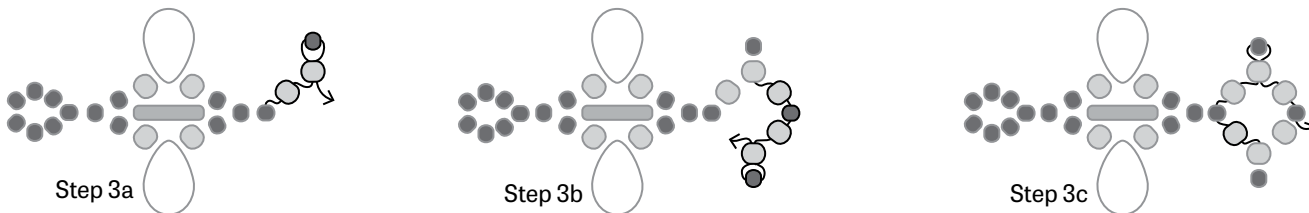

- Repeat Steps 2 through 3 for a total of 11 CMB, ending with a Drop Segment. Use the outermost SB15 to form a loop for the clasp as in Step 1. Attach clasp after tying off.

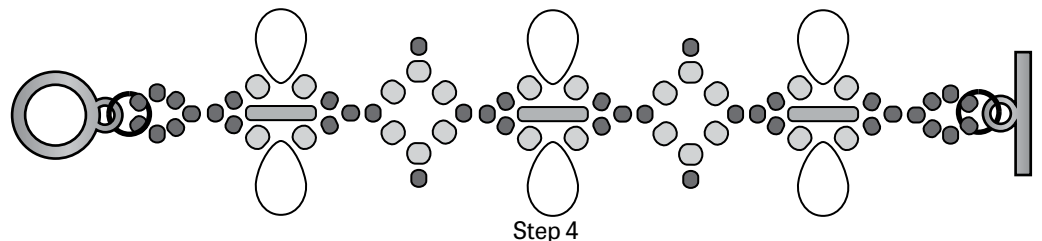

MATERIALS

- 11 CzechMates® Bar (CMB)
- 22 Czech Tear Drop 6/4mm (TD)
- 3g 11° TOHO Round Seed Beads (SB11)
- 2g 15° TOHO Round Seed Beads (SB15)
- 2 Jump rings (optional)
- Clasp of Choice
- Thread of Choice

Bracelet as instructed measures approx. 6.75" before clasp. Bar segment adds 1/8". Diamond segment adds 1/4".